

First Floor

- 1** Information Desk
- 2** Vending
- 3** Gift Shop
- 4** Outpatient Registration
- 5** Outpatient Registration/
Lab Draw
- 6** Chapel
- 7** NICT Stress Lab
- 8** Cafeteria
- 9** Diagnostic Imaging
- 10** Clinical Decision Unit
- 11** Cardiopulmonary
- 12** Business Offices
- 13** Mechanical
- E** Elevator
- S** Stairs
- R** Restroom



Second Floor

- 1** Patient Waiting
- 2** Patient Rooms 203-205
- 3** Patient Rooms 206-211
- 4** Patient Rooms 212-217
- 5** Patient Rooms 218-222
- 6** Med/Surg Nurses Station
- 7** ICU Nurses Station
- 8** ICU Patient Rooms 1-8
- 9** Cath Lab
- 10** Emergency Department
- E** Elevator
- S** Stairs
- R** Restroom

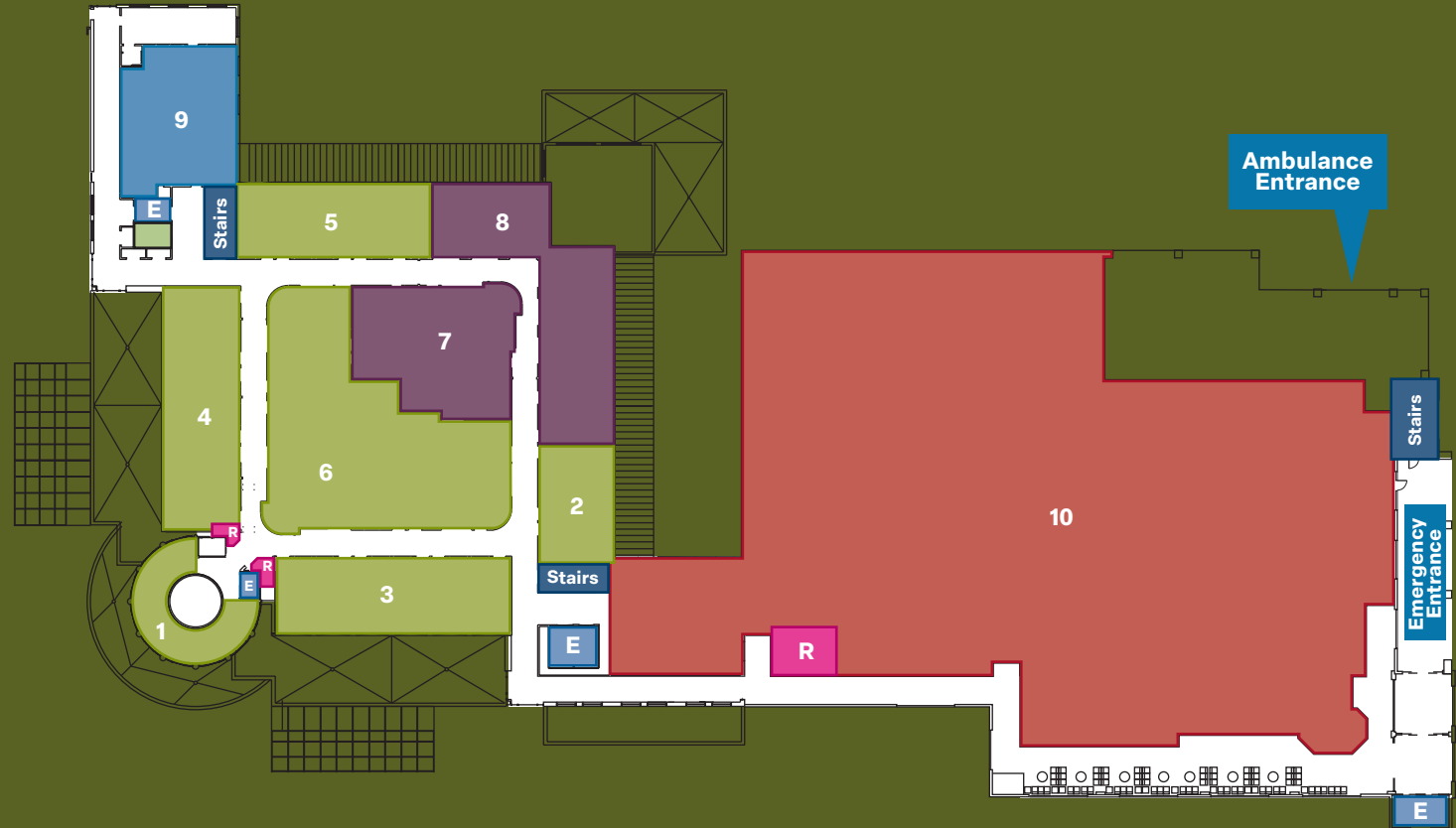

Third Floor

- 1** 3rd Floor Waiting
- 2** Labor and Delivery
- 3** OB/GYN Nurses Station
- 4** Nursery
- 5** Patient Rooms 301-308
- 6** Patient Rooms 309-316
- 7** Surgical Services/
Outpatient Surgery
- 8** Transition Support Unit

- E** Elevator
- S** Stairs
- R** Restroom

